

VERSION	AMENDMENT	AUTHORISED BY	DATE

HELD BY LANDGATE IN DIGITAL FORMAT ONLY

UNLODGED VERSION

AMENDMENTS TABLE		
Revision	Description	Date
A	Initial Issue	05/08/2020
B	Amend after PM audit	14/08/2020

**DRAFT**  
ALL AREAS AND DIMENSIONS  
ARE SUBJECT TO FINAL SURVEY  
AND WAPC APPROVAL

SURVEY CARRIED OUT UNDER REG 26A  
SPECIAL SURVEY AREA GUIDELINES  
SEE SURVEY SHEETS FOR SURVEY INFORMATION

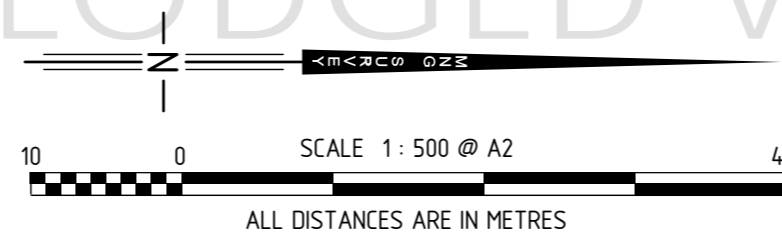

USE ONLY THE SURVEY SHEET/S WHEN DETERMINING  
THE TRUE FINAL POSITION AND TYPE OF ALL SURVEY  
MARKS PLACED PERTAINING TO THIS PLAN.

FORMER TENURE TABLE

LOT	FORMER TENURE	ON PLAN / DIAGRAM	TITLE
LOTS 2691, 2692, 2697-2700, 3011	PT LOT 9047	DP 4 10853	2928-216
LOTS 2685-2689, 2702-2715, 2754, 2755, 3012, 9061	PT LOT 9048	DP 4 10853	2928-217
LOTS 2690, 2701	PT LOT 9047 PT LOT 9048	DP 4 10853	2928-216 2928-217

REG 26A(1) - FINAL MARKING DEFERRED  
(APPROVAL ID ???-?? DATED 00 MONTH YEAR, LANDGATE FILE 000??-201?)

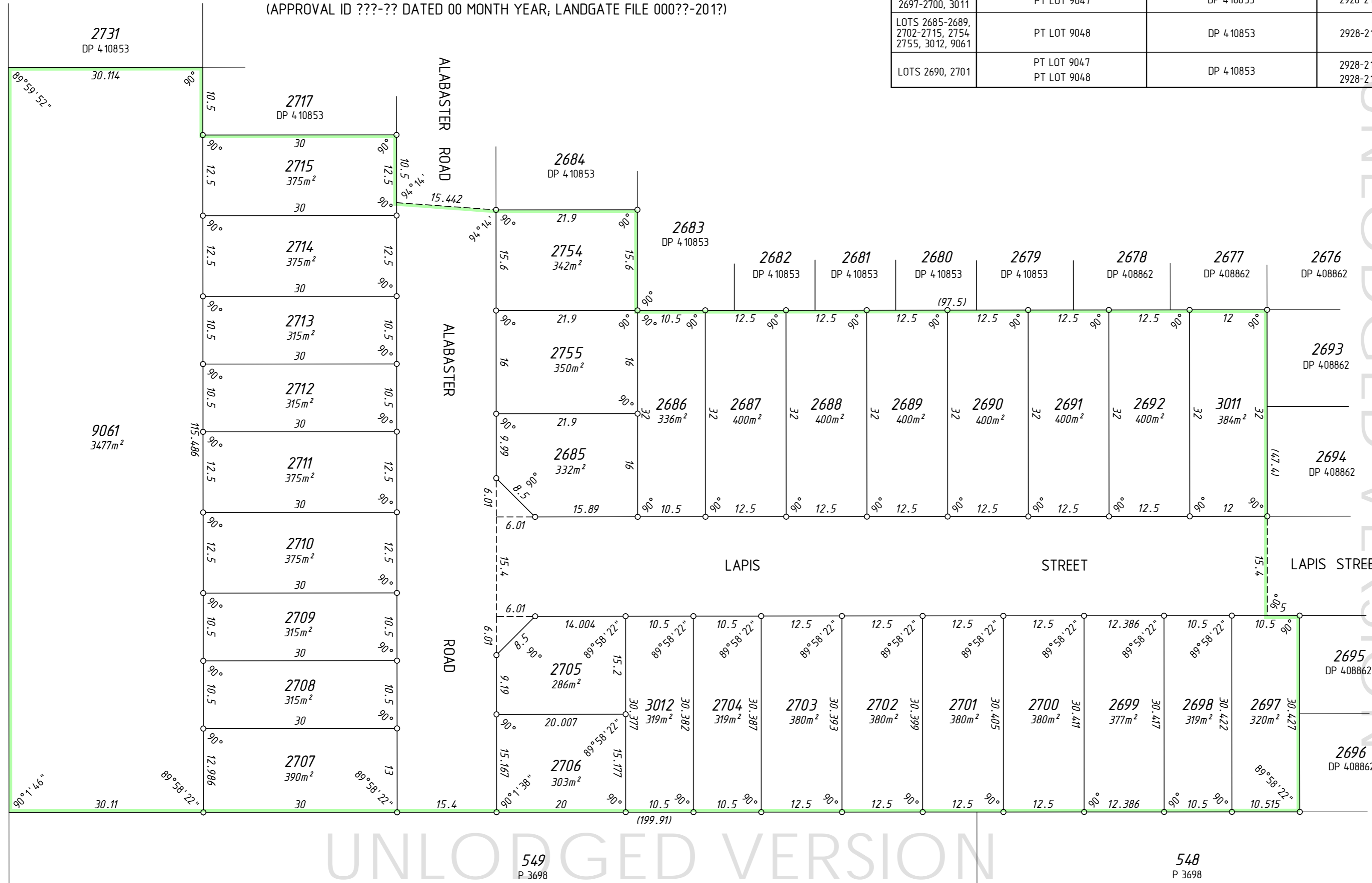

TYPE	FREEHOLD	S.S.A.	YES
PURPOSE	SUBDIVISION		
PLAN OF	LOTS 2685-2692, 2697-2715, 2754, 2755 3011, 3012, 9061, ROADS AND RESTRICTIVE COVENANT		
FORMER TENURE	SEE FORMER TENURE TABLE		
LOCAL AUTHORITY	CITY OF SWAN		
LOCALITY	DAYTON		
D.P.L.H. FILE			
FIELD RECORD	133848		
SURVEYOR'S CERTIFICATE - REG 54			
I, Matthew B. WEBB hereby certify that this plan is accurate and is a correct representation of the - (a) *survey, and/or (b) *calculations from measurements recorded in the field records, [* delete if inapplicable] undertaken for the purposes of this plan and that it complies with the relevant written law(s) in relation to which it is lodged.			
LICENSED SURVEYOR	DATE		
LODGED			
DATE	FEE PAID	ASSESS No.	
I.S.C.			
EXAMINED			
DATE			
WESTERN AUSTRALIAN PLANNING COMMISSION FILE 158620			
Delegated under S. 16 P&D Act 2005			
DATE			
IN ORDER FOR DEALINGS			
SUBJECT TO			
FOR INSPECTOR OF PLANS AND SURVEYS			
DATE			
APPROVED REG26A (1), (4)			
INSPECTOR OF PLANS AND SURVEYS (S. 18 Licensed Surveyors Act 1909)			
DATE			

INTERESTS AND NOTIFICATIONS

SUBJECT	PURPOSE	STATUTORY REFERENCE	ORIGIN	LAND BURDENED	BENEFIT TO	COMMENTS
	RESTRICTIVE COVENANT	SEC 136D OF THE T.L.A	THIS PLAN & DOC	ALL LOTS EXCEPT 9061	ALL LOTS EXCEPT 9061	

**PRELIMINARY ONLY  
UNLODGED VERSION  
SUBJECT TO  
LANDGATE AUDIT**

This version is  
- Current as at 8/14/2020  
- Subject to change without notice  
- Not intended for design use,  
a LANDGATE APPROVED copy  
should be obtained for such purposes.

MC MULLEN NOLAN GROUP  
PO Box 3526, Success W.A. 6964  
Tel: (08) 6436 1599  
Fax: (08) 6436 1500  
Email: info@mngsurvey.com.au

MNG Ref : 99352dp-045b - Stage 3A - DP4 19844.CSD



DEPOSITED PLAN  
**4 19844**  
SHEET 01 OF 01 SHEETS  
(PLUS SURVEY SHEETS(S))  
VERSION 1

FOR HEADING SEE SHEET 1

UNLODGED VERSION

PRELIMINARY ONLY  
UNLODGED VERSION  
SUBJECT TO  
LANDGATE AUDIT

This version is  
- Current as at 8/14/2020  
- Subject to change without notice  
- Not intended for design use,  
a LANDGATE APPROVED copy  
should be obtained for such purposes.

UNLODGED VERSION

UNLODGED VERSION

THIS SURVEY SHEET WILL BE  
REPLACED BY THE SURVEY DATA

UNLODGED VERSION  
HELD BY LANDGATE IN DIGITAL FORMAT ONLY



MNG Ref: 99352dp-045b



GOVERNMENT OF  
WESTERN AUSTRALIA

DEPOSITED PLAN  
**4 19844**  
SURVEY SHEET